



# AHL-LIGHT 10

## LED WORK LIGHT

The Ahl-Light 10 is a underwater LED work light that can be used with robots and manipulators, or attached to tools for inspection. With a color temperature similar to traditional halogen lights, but with a significantly longer lifetime, it has many suitable applications.

## APPLICATIONS

- Can be attached to tools, robots, manipulators and more when working with internal parts and fuel assemblies in reactor and fuel pools.
- Ideal for use during inspections such as a 4-face fuel inspection
- Powered by a camera control unit or a lighting power unit

## BENEFITS

- 9 000 lumen light output
- Color temperature suitable for inspections
- Low maintenance cost due to its long life-time

## SPECIFICATIONS

Diameter	93 mm (3.7")
Height	95 mm (3.7")
Weight	1.0 kg (2.3 lbs)
Housing material	Stainless steel EN 1.4301, AISI 304/AISI 316
Front glass material	Polycarbonate
Maximum temperature	50°C, 70°C for short periods (122°F, 158°F)
Water tightness	min 3.5 bar (35 m)
Lights	LED
Typical luminous flux	9 000 lumen
Lighting beam angle	64°
Life time	>50 000 h
Radiation tolerance (total dose)	50 000 Gy (5 000 000 rad)

*We reserve the right to alter specifications without prior notice*

## AHL-LIGHT 10 IMAGES

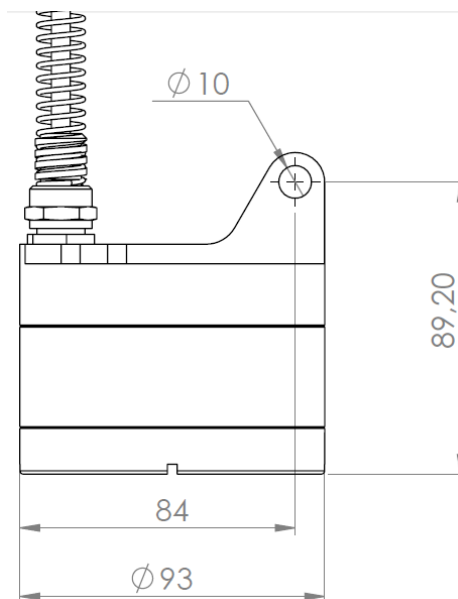

*We reserve the right to alter specifications without prior notice*