



CCTV90

HIGH TEMPERATURE AND NEUTRON TOLERANT CCTV CAMERA

The CCTV90 is designed for areas with high levels of gamma and neutron radiation. A typical surveillance area is the containment in a PWR/BWR reactor. The camera features an internal cooling system in order to handle high temperatures and humidity in the containment during a possible LOCA.

APPLICATIONS

- CCTV camera for nuclear plant areas with high levels of gamma and neutron radiation.
- Surveillance of containment or drywell where possible high temperature is handled by the camera's internal cooling system

BENEFITS

- Auto-focus and auto-iris
- Neutron radiation tolerant color camera
- High temperature tolerant
- Available in SD/HD video versions

SPECIFICATIONS

| | |
|----------------------------------|---|
| Dimensions | 364 x 217 x 272 mm (14.33" x 8.54" x 10.71") |
| Weight | 33.2 kg (73.2 lbs) |
| Housing material | Stainless steel EN 1.4301 |
| Radiation tolerance (dose rate) | 1 000 Gy/h (100 000 rad/h) |
| Radiation tolerance (total dose) | 10 000 Gy (1 000 000 rad) |
| Radiation tolerance neutrons | High |
| Maximum temperature | 60°C (140°F), 90°C (194°F) for 5 hours |
| Cooling | Peltier elements |
| Protection class | IP65 |
| Zoom | x10 optical x10 digital giving x100 |
| SD horizontal angle of view | approx. 37.5° (wide end), approx. 4° (tele end) |
| HD horizontal angle of view | Approx. 50° (wide end), approx. 5° (tele end) |
| Resolution SD version | 720 TV-lines |
| Resolution HD version | 720p |

We reserve the right to alter specifications without prior notice

CCTV90 IMAGES

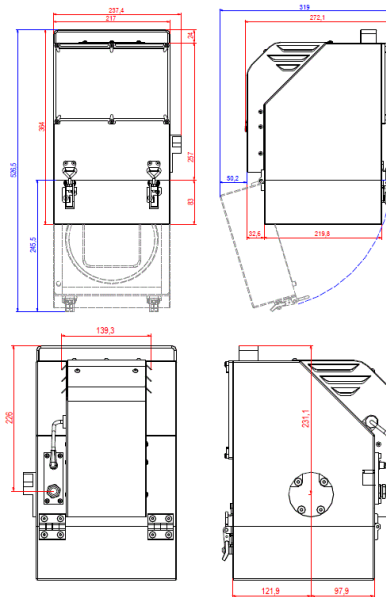

We reserve the right to alter specifications without prior notice