



Z630

HD ZOOM CAMERA

The Z630 is a radiation-tolerant color-zoom camera. The camera features high-quality focus and close-up capabilities and is equipped with twelve high-powered LED lights attached to the front. The Z630 is ideal for use in areas with limited space such as the belt-line area and inside nozzles and pipes.

APPLICATIONS

- Ideal for use in high-radiation areas with limited space such as the belt-line area and inside nozzles and pipes
- For close-up inspection in high radiation areas
- Ideal to mount on a range of manipulator and underwater tool systems

BENEFITS

- Auto-focus and auto-iris
- Small camera, diameter 62 mm
- 12 high powered LED lights
- Available in SD/HD versions

SPECIFICATIONS

Diameter	62 mm (2,44")
Length	264 mm (10,39")
Weight	6 kg (13,2 lbs)
Housing material	Stainless steel EN 1.4301/EN 1.4436, AISI 304/AISI 316, anodized aluminum
Radiation tolerance (dose rate)	500 Gy/h (50 000 rad/h)
Radiation tolerance (total dose)	5 000 Gy (500 000 rad)
Maximum temperature	50°C (122°F)
Water tightness	min 3,5 bar, 50psi
Zoom	x10 optical x10 digital giving x100
Minimum distance to object	5 mm (0,20")
SD horizontal angle of view	36° (wide end), 5.1° (tele end)
HD horizontal angle of view	50° (wide end), 5.4° (tele end)
Resolution SD version	720 TV-lines
Resolution HD version	720p
Lights, optional	12 ea high power internal LED lights

We reserve the right to alter specifications without prior notice

Z630 IMAGES

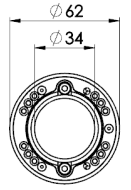
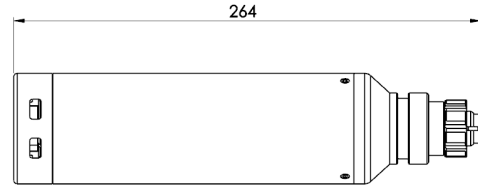

We reserve the right to alter specifications without prior notice