



CCTV95

HIGH TEMPERATURE GAMMA AND NEUTRON TOLERANT CCTV CAMERA

ahlbergcameras.com/products/cctv-cameras/cctv95



The CCTV95 is designed for areas with high levels of temperature, gamma and neutron radiation. A typical surveillance area is the steam generator boxes of VVER reactors. The camera features an internal cooling system for handling high temperatures and humidity in the containment during a potential loss of cooling accident (LOCA).

MORE INFORMATION ABOUT CCTV95

APPLICATIONS

- CCTV camera for nuclear plant areas with high levels of temperature, gamma and neutron radiation
- Surveillance of containment or drywell where possible high temperature is handled by the camera's internal cooling system

BENEFITS

- Auto-focus and auto-iris
- Gamma and neutron-protection
- Easy maintenance
- Active cooling for high ambient temperatures
- Available in SD/HD video versions

SPECIFICATIONS

PHYSICAL CHARACTERISTICS

Width	217 mm
Length	272 mm
Height	364 mm
Weight	41.1 kg
Housing material	Stainless steel EN 1.4301
Front glass material	Polycarbonat

OPTICAL FEATURES

Resolution SD	>700 TV-lines (optional)
Resolution FHD	1080p, 720p (optional)
Zoom	x40 (x10 optical, x4 digital)
Horizontal Angle View SD	40° (wide end), 4° (tele end)
Horizontal Angle View FHD	50° (wide end), 5° (tele end)

ENVIRONMENTAL TOLERANCES

Radiation Tolerance (dose rate)	1 800 Gy/h (180 000 rad/h)
Radiation Tolerance (total dose)	18 000 Gy (1 800 000 rad)
Maximum Operating Temperature	60°C, 90°C for 5h

We reserve the right to alter specifications without prior notice

COOLING

Cooling type

Thermo electric cooling

We reserve the right to alter specifications without prior notice

CCTV95 IMAGES

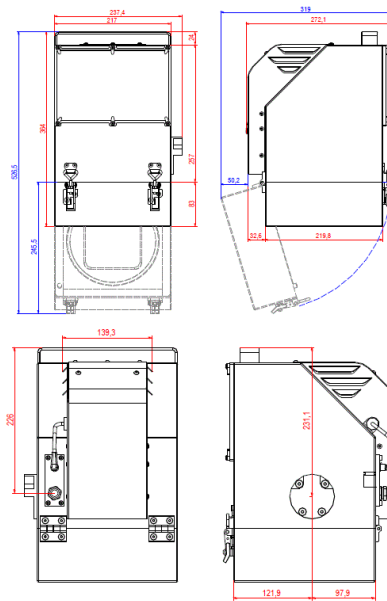

We reserve the right to alter specifications without prior notice