



# CCTV LED 5

## POWERFUL CCTV LED LIGHT

[ahlbergcameras.com/products/lights/cctv-led-5](http://ahlbergcameras.com/products/lights/cctv-led-5)



The CCTV LED 5 is a robust radiation tolerant CCTV LED light unit with high power illumination. The unit is equipped with brand new LED technology giving 5 000 Lumens.

## MORE INFORMATION ABOUT CCTV LED 5

### APPLICATIONS

- For nuclear CCTV applications where high illumination is needed and/or the objects are far away from the camera

### BENEFITS

- High radiation tolerance
- Powerful illumination and intensity
- 50 000 hours lifetime
- Its cable is halogen free and flame retardant

## SPECIFICATIONS

### PHYSICAL CHARACTERISTICS

Width	120 mm
Length	80 mm
Height	105 mm
Weight	1.4 kg
Housing material	Painted aluminum

### LIGHTING FEATURES

Type	LED
Typical luminous flux	5 000 lumen
Life time	50 000 h

### ENVIRONMENTAL TOLERANCES

Radiation tolerance (total dose)	100 000 Gy (10 000 000 rad)
Maximum operating temperature	60°

### POWER

Power consumption	45 W
-------------------	------

*We reserve the right to alter specifications without prior notice*

## CCTV LED 5 IMAGES

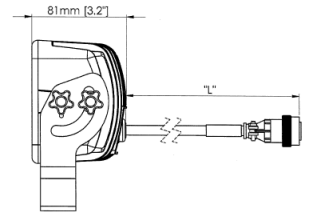
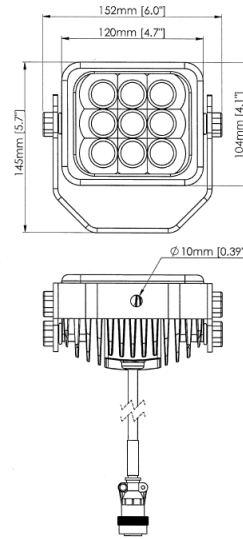

*We reserve the right to alter specifications without prior notice*